



Costa Mesa High School

Costa Mesa, CA

Tremco

PROJECT: COSTA MESA HIGH SCHOOL
BRANCH: COSTA MESA, CA
ROOFING CONTRACTOR: TREMCO

TAPER SPECS
TAPERED MATERIAL: Polyiso 20psi
TAPERED SLOPE: 1/8"
MINIMUM THICKNESS: 0.50"
MAXIMUM THICKNESS: 8.28"
R-VALUE (AVG/MIN): AVG R-11.15

CRICKET SPECS
CRICKET MATERIAL: Polyiso 20psi
CRICKET SLOPE: 1/4"
MINIMUM THICKNESS: 0.00" w/TES
MAXIMUM THICKNESS: 2.50"

PROJECT NOTES:



NOTES:
INSTALLER MUST VERIFY ALL FIELD DIMENSIONS, DRAIN AND SCUPPER LOCATIONS AND PRODUCT SPECIFICATIONS FOR ACCURACY. MATERIAL WILL BE SHIPPED TO MATCH THE SPECIFICATIONS AND QUANTITIES NOTED HEREON. CONTRACTOR IS RESPONSIBLE FOR VERIFICATION OF ALL FIELD CONDITIONS AND COMPLIANCE WITH BUILDING CODE ISSUES.

THE TAPERED LAYOUT ILLUSTRATED ON THIS DRAWING REQUIRES THE INSTALLER TO REUSE PARTIAL PIECES OF INSULATION, THEREFORE, DISCARDING MORE THAN HALF OF A USEABLE PIECE OF TAPERED INSULATION AND/OR ONE QUARTER OF A PIECE OF FLAT INSULATION WILL RESULT IN A SHORTAGE OF MATERIAL FOR YOUR TAPERED SYSTEM.

DISCLAIMER:
BEACON ENGINEERING DID NOT PERFORM AND OR CONDUCT ANY DESIGN OR ENGINEERING ANALYSIS IN CONJUNCTION WITH THE PREPARATION OF THESE DRAWINGS. THESE DRAWINGS REPRESENT A RECITATION AND GRAPHIC DEPICTION OF THE MANUFACTURERS SPECIFICATIONS AND THE DESIGN DETAILS ONLY. THESE DRAWINGS SHOULD NOT AND ARE NOT TO BE CONSTRUED AS CONSTITUTING DESIGN ERECTION DRAWINGS. SPECIFICATIONS OR DESIGN DETAILS PREPARED OR APPROVED BY BEACON ENGINEERING. THE ARCHITECT'S/ENGINEER'S APPROVED DESIGN OF THE ROOF IS THE CONTROLLING DOCUMENT. CONTRACTOR REMAINS RESPONSIBLE FOR THE INSTALLATION IN COMPLIANCE WITH THAT APPROVED DESIGN.

DATE: 10/9/2019
PROJECT NUMBER: F19-36859-R1
QUOTE NUMBER: Q191009-129
DRAWN BY: R. Evans

DRAWING PAGES: 1 OF 1

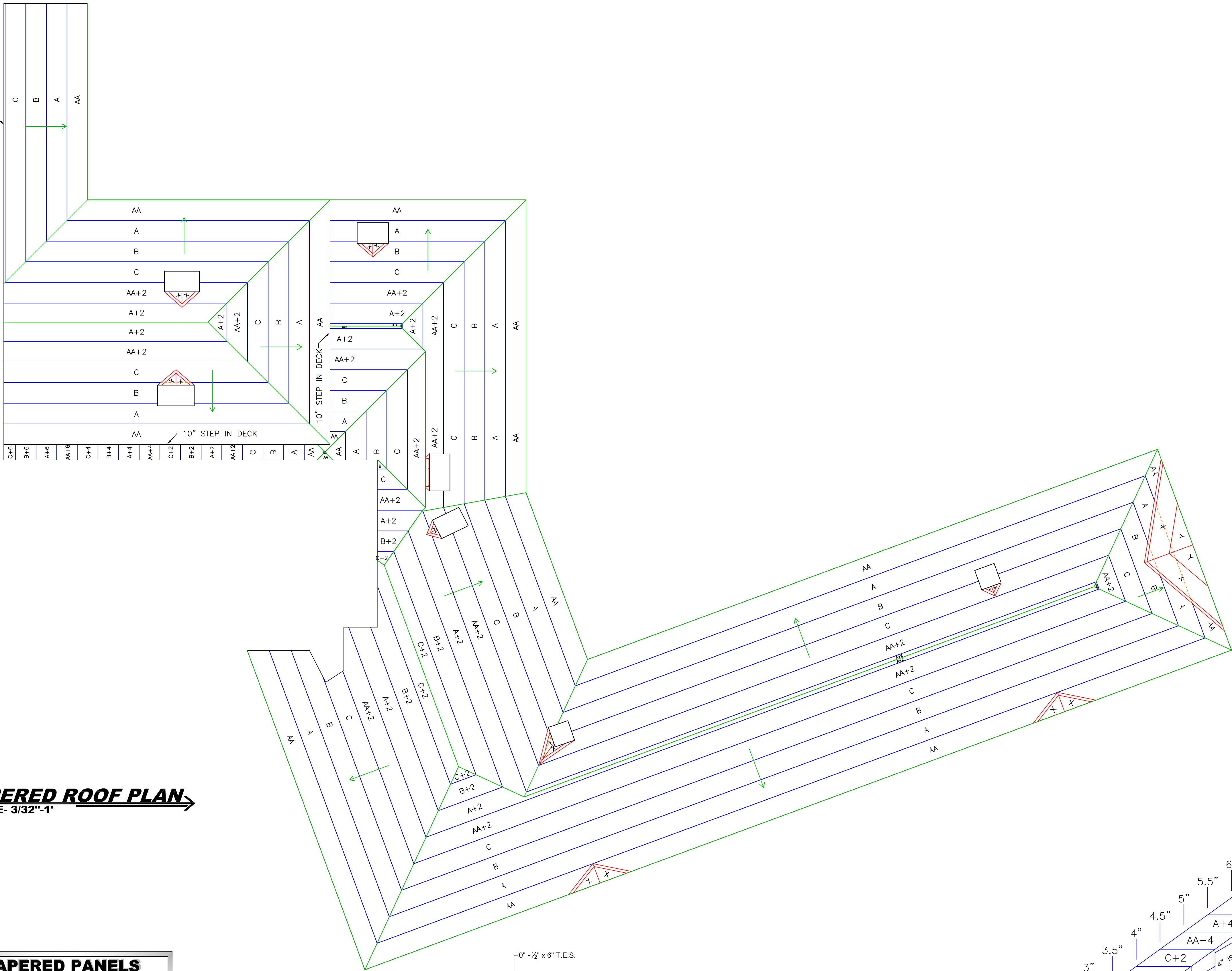

TAPERED PANELS		
PANEL	DIMENSION	SLOPE
AA	1/2" - 1"	1/8"
A	1" - 1 1/2"	1/8"
B	1 1/2" - 2"	1/8"
C	2" - 2 1/2"	1/8"
X	1/2" - 1 1/2"	1/4"
Y	1 1/2" - 2 1/2"	1/4"
6" TES	0" - 1/2"	1"

